

# MOUNTING BRACKET SPECIFICATIONS FOR ALUMINUM HOUSINGS (300 SERIES)

## Features:

- Simple Rugged Design
- User Friendly
- Available For Most Housings

## Materials of Construction:

- MBSS315 & MBSS360
  - 316L Stainless Steel
- MB380, MB380-3779, & MB385
  - Powder Coated Carbon Steel

Mounting Bracket	DIMENSIONS					
	A	B	C	D	E	F
MBSS315	0.98" (25mm)	1.50" (38mm)	1.73" (44mm)	0.24" (6mm)	0.08" (2mm)	0.79" (20mm)
MBSS360	1.61" (41mm)	2.36" (60mm)	2.36" (60mm)	0.24" (6mm)	0.08" (2mm)	1.14" (29mm)
MB380	2.52" (64mm)	3.94" (100mm)	3.94" (100mm)	0.44" (11mm)	0.12" (3mm)	1.97" (50mm)
MB380-3779 (1)	2.52" (64mm)	3.94" (100mm)	3.94" (100mm)	0.44" (11mm)	0.12" (3mm)	1.97" (50mm)
MB385	3.50" (89mm)	5.50" (140mm)	5.75" (146mm)	0.44" (11mm)	0.12" (3mm)	3.31" (84mm)

Notes: (1) Center portion cut off to accept Visual Differential Indicator kit. "All dimensions are the same"

Mounting Bracket	MOUNTING HOLES	
	Mounting Bracket	Set-Up Mounting Holes
MBSS315		M5 x 3/8" deep on 0.94" Centers
MBSS360		M6 x 1/2" deep on 1.59" Centers
MB380		M10 x 5/8" deep on 2.50" Centers
MB380-3779		M10 x 5/8" deep on 2.50" Centers
MB385		M10 x 5/8" deep on 3.50" Centers

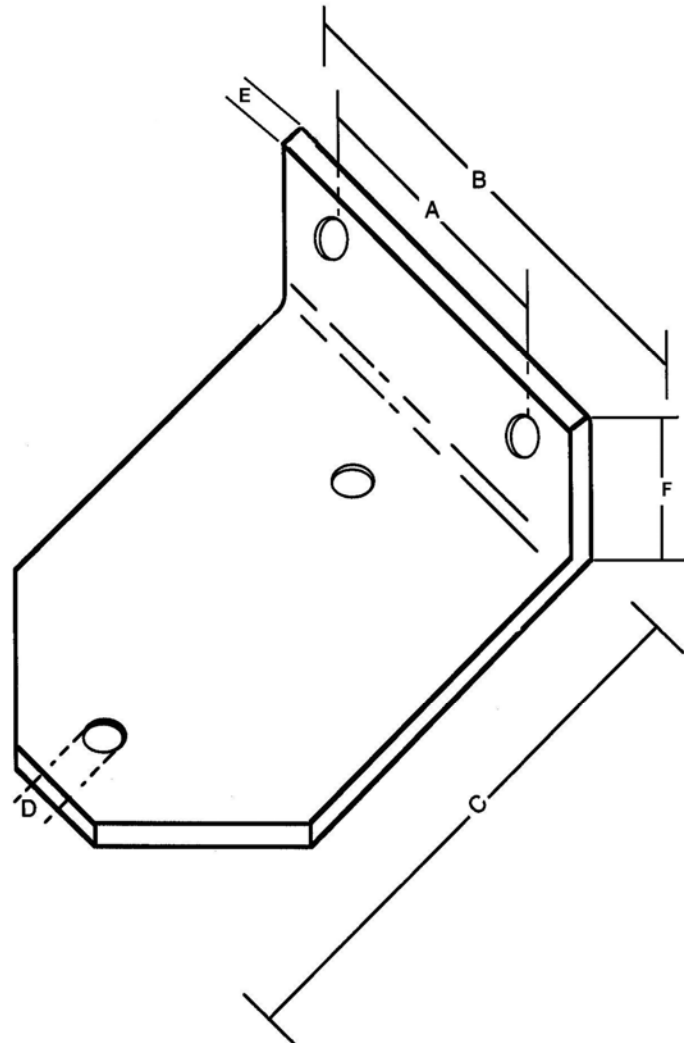

United Filtration Systems, Inc.  
 6558 Diplomat Drive  
 Sterling Heights, MI 48314  
 T (586) 802-5561 • F (586) 802-5562  
 sales@unitedfiltration.com  
 www.unitedfiltration.com

1-800-311-5561



Partner of Headline Filters

MB300-1